

## Pershing 5X#01- IPS



### TECHNICAL DATA

Engines:	2X 725MHP VOLVO D11+IPS950
Transmission	IPS950
Loa (overall length)	16,51 m (54 ft. 02 in)
Lh (hull length)	15,37 m (50ft. 05 in)
Maximum beam	4,38 m (14 ft.4 in)
Depth under propellers	1,35 m (4 ft. 05 in)
Displacement unladen	20,86 ton
Displacement laden	25 ton
Cruising speed	30kn
Top speed	35 kn
Range at cruising speed	285 n.m.

### MAIN STANDARD FEATURES

2 cabins layout  
 Full beam master cabin with bathroom en suite  
 Lower dinette with relax area and galley  
 aft door  
 TV Led 32" in upper salon  
 Generator 7kw - 50 Hz  
 A/C 32.000 Btu for upper saloon  
 Garage for tender (tender 2,80 mt. OPT)  
 Harman Kardon system in upper salon and master cabin  
 Wooden, mat flooring, in bathrooms

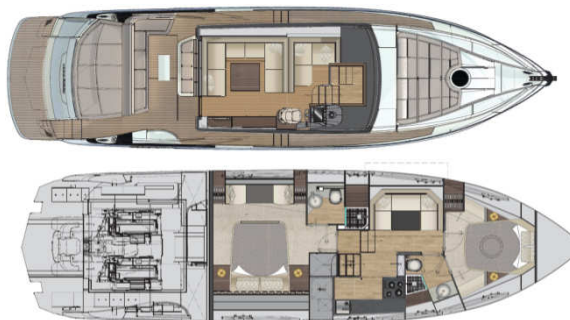

### NOTES:

[illegible]